

V36 Dry Sprinkler with Integral Style AB6 Assembly

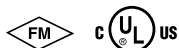

Approvals/Listings:



[See Victaulic Publication 10.01 for more details.](#)

Product Description:

The VicFlex™ V36 Dry Sprinkler with Integral Style AB6 Bracket Assembly provides dry sprinkler installation in cold storage applications utilizing a V36 Dry Sprinkler, flexible stainless steel hose, and steel bracket assembly. This assembly is suitable for wet sprinkler systems only. Refer to the Installation Instructions, I-VICFLEX.AB6, for all applicable ceiling and wall specifications and installation details.

• V36 Dry Sprinkler:

Please refer to submittal publication number 40.60, 40.61 or 40.64 for FM data on the following models and styles:

Model: V3605, V3606, V3607, V3608, V3609, V3610

Style: Pendent, Horizontal Sidewall (Flush, Sleeve/Skirt Only)

• Hose:

Series AH2, 1" Nominal ID Braided Hose

Note: Reducer not included with AB6 assembly. Nominal hose lengths include 5.75"/140mm standard reducer for wet systems. Please make appropriate deductions when calculating necessary hose lengths.

• Bracket:

Style AB6 for cold storage applications, factory assembled to V36 Dry Sprinkler

Job/Owner

| | |
|------------|--|
| System No. | |
| Location | |

Contractor

| | |
|--------------|--|
| Submitted By | |
| Date | |

Technical Specifications:

V36 Dry Sprinkler –

Maximum K-Factor of Sprinkler:

- K8.0/11,5 (S.I.)

Series AH2 Braided Hose –

Maximum Working Temperature: 225°F/107°C

Maximum Working Pressure:

- 175 psi/1375 kPa

Connections:

To branch line (inlet) via 1"/25 mm NPT/BSPT male thread

Minimum Bend Radius of Flexible Hose:

- 7"/178 mm (FM Approval)
- 2"/51 mm (cULus Listed)

Maximum Number of Bends per Flexible Drop:

See friction loss charts below

Engineer

| | |
|--------------|--|
| Spec Section | |
| Paragraph | |
| Approved | |
| Date | |

Material Specifications:

• **V36 Dry Sprinkler:**

Please refer to submittal publication number 40.60, 40.61, or 40.64 for material specifications on the following models and styles:

Model: V3605, V3606, V3607, V3608, V3609, V3610

Style: Pendent, Horizontal Sidewall (Flush, Sleeve/Skirt Only)

• **Series AH2 Braided Flexible Hose:**

Flexible Hose: Type 304 Stainless Steel

Collar/Weld Fitting: Type 304 Stainless Steel

Gasket Seal: Victaulic Grade EV EPDM

Isolation Ring: Nylon

Nut and Nipple: Carbon Steel, Zinc Plated

• **Style AB6 Bracket Assembly:**

Adapter: Carbon Steel, Zinc-Plated

Threaded Sleeve: Carbon Steel, Zinc-Plated

Rubber Plug: Silicone Rubber

Sleeve: Carbon Steel, Zinc-Plated / Chrome-Plated / White-Painted

Base Plate: Carbon Steel, Zinc-Plated / Chrome-Plated / White-Painted

Hex Nut: Carbon Steel, Zinc-Plated

Internal Tooth Lock Washer: Carbon Steel, Zinc-Plated

O-Ring (ID of Threaded Sleeve): Silicone Rubber

• **Optional:**

Right Angle Adapter: Carbon Steel, Zinc-Plated

Wrench: Ductile Iron

Toggle Tool: Aluminum

Spacer: Carbon Steel, Zinc-Plated

 **Friction Loss Data - Series AH2 Braided Hose for use with Style AB6 VicFlex Bracket Assembly**

| Length of Stainless Steel Flexible Hose ¹ inches | Sprinkler K-Factor | Outlet type | Series AH2 Hose | |
|--|--------------------|----------------|---|--|
| | | | Equivalent Length of 1"/33.7mm Sch. 40 Pipe feet meters | Maximum Number of 90° Bends at 2"/51mm Bend Radius |
| 31 | 5.6/8.1 | Straight | 17.0/5.2 | 4 |
| | | 90° Elbow | 17.0/5.2 | |
| 36 | 5.6/8.1 | Straight | 23.0/7.0 | 5 |
| | | 90° Elbow | 23.0/7.0 | |
| 48 | 5.6/8.1 | Straight | 37.0/11.3 | 8 |
| | | 90° Elbow | 37.0/11.3 | |
| 60 | 5.6/8.1 | Straight | 46.0/14.0 | 10 |
| | | 90° Elbow | 46.0/14.0 | |
| 72 | 5.6/8.1 | Straight | 56.0/17.1 | 12 |
| | | 90° Elbow | 56.0/17.1 | |
| 31 | 8.0/11.5 | Straight | 17.0/5.2 | 4 |
| | | 90° Elbow | 17.0/5.2 | |
| 36 | 8.0/11.5 | Straight | 23.0/7.0 | 5 |
| | | 90° Elbow | 23.0/7.0 | |
| 48 | 8.0/11.5 | Straight | 37.0/11.3 | 8 |
| | | 90° Elbow | 37.0/11.3 | |
| 60 | 8.0/11.5 | Straight | 46.0/14.0 | 10 |
| | | 90° Elbow | 46.0/14.0 | |
| 72 | 8.0/11.5 | Straight | 56.0/17.1 | 12 |
| | | 90° Elbow | 56.0/17.1 | |

1 Reducer not included with AB6 assembly. Nominal hose lengths include 5.75"/140mm standard reducer for wet systems. Please make appropriate deductions when calculating necessary hose lengths.



Friction Loss Data - Series AH2 Braided Hose for use with Style AB6 VicFlex Bracket Assembly

| Length of Stainless Steel Flexible Hose ² inches | Sprinkler K-Factor | Outlet type | Series AH2 Hose | |
|--|--------------------|----------------|---|---|
| | | | Equivalent Length of 1"/33.7mm Sch. 40 Pipe feet meters | Maximum Number of 90° Bends at 7"/178mm Bend Radius |
| 31 | 5.6/8.1 | Straight | 23.5/7.1 | 2 |
| | | 90° Elbow | 23/7.0 | |
| 36 | 5.6/8.1 | Straight | 27.8/8.5 | 2 |
| | | 90° Elbow | 27.7/8.4 | |
| 48 | 5.6/8.1 | Straight | 38.2/11.6 | 3 |
| | | 90° Elbow | 37.4/11.4 | |
| 60 | 5.6/8.1 | Straight | 42.4/12.9 | 4 |
| | | 90° Elbow | 43/13.1 | |
| 72 | 5.6/8.1 | Straight | 46.6/14.2 | 4 |
| | | 90° Elbow | 48.5/14.7 | |
| 31 | 8.0/11.5 | Straight | 20.7/6.3 | 2 |
| | | 90° Elbow | 20.5/6.2 | |
| 36 | 8.0/11.5 | Straight | 25.0/7.6 | 2 |
| | | 90° Elbow | 24.6/7.5 | |
| 48 | 8.0/11.5 | Straight | 35.5/10.8 | 3 |
| | | 90° Elbow | 34.7/10.6 | |
| 60 | 8.0/11.5 | Straight | 39.6/12.1 | 4 |
| | | 90° Elbow | 40.1/12.2 | |
| 72 | 8.0/11.5 | Straight | 43.5/13.2 | 4 |
| | | 90° Elbow | 45.2/13.7 | |

2 Reducer not included with AB6 assembly. Nominal hose lengths include 5.75"/140mm standard reducer for wet systems. Please make appropriate deductions when calculating necessary hose lengths.

Sprinkler Barrel Length Selection

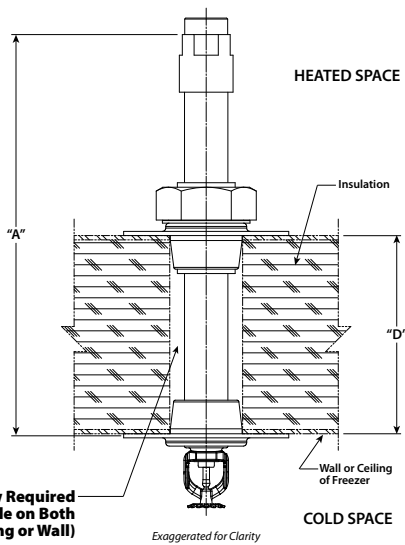

| Temperature Maintained at 40°F/40°C Minimum | | |
|---|--|--------------------------|
| Ambient Temperature Exposed to Discharge End of Sprinkler | "D" Freezer Ceiling or Wall Thickness | "A" Order Length |
| Down to 20°F Down to -6.7°C | 3 – 6"/76 – 152 mm 6 – 1"/152 – 305 mm | 10"/254 mm 16"/406 mm |
| 19°F to 0°F -7.2°C to -17.8°C | 3 – 6"/76 – 152 mm 6 – 12"/152 – 305 mm | 18"/457 mm 24"/610 mm |
| -1°F to -20°F -18.3°C to -28.9°C | 3 – 6"/76 – 152 mm 6 – 12"/152 – 305 mm | 20"/508 mm 26"/660 mm |
| -21°F to -30°F -29.4°C to -34.4°C | 3 – 6"/76 – 152 mm 6 – 12"/152 – 305 mm | 22"/559 mm 28"/711 mm |
| -31°F to -40°F -35.0°C to -40.0°C | 3 – 6"/76 – 152 mm 6 – 12"/152 – 305 mm | 24"/610 mm 30"/762 mm |

Note:

Exposed minimum barrel lengths are inclusive up to 30-mph/48-kph wind velocities.

Product Details and Optional Components

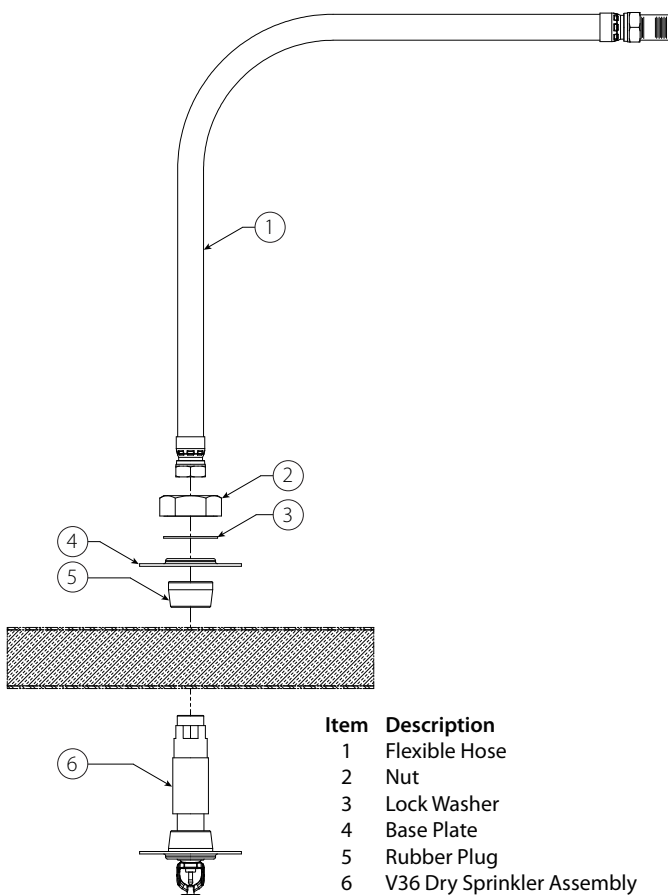

| Nominal Hose Length | A |
|---------------------|-------|
| 31 | 25.25 |
| 36 | 31.25 |
| 48 | 42.25 |
| 60 | 54.25 |
| 72 | 66.25 |

Note: Reducer not included with AB6 assembly. Nominal hose lengths include 5.75"/140mm standard reducer for wet systems. Please make appropriate deductions when calculating necessary hose lengths.

Optional Components:

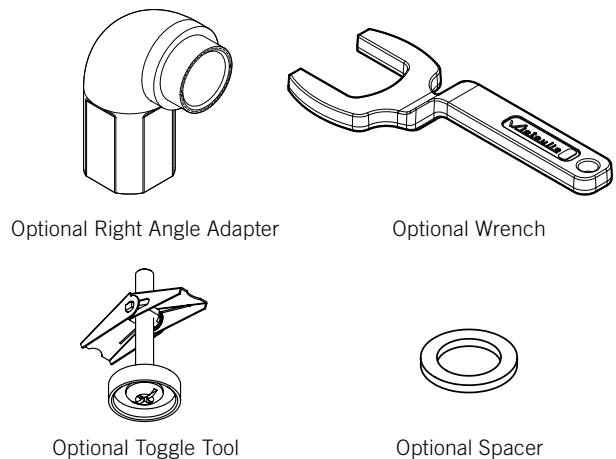

Assembly Weights

| Total weight (lbs) of V36 Dry Sprinkler, Series AH2 Braided Hose (water-filled), and Style AB6 assembly | | | | | | | | | | |
|--|--------------------------|------------------|--------------------------|------------------|--------------------------|------------------|--------------------------|------------------|--------------------------|------------------|
| V36 AB6 Order Length "A" ³ | AH2-31 hose ⁴ | | AH2-36 hose ⁴ | | AH2-48 hose ⁴ | | AH2-60 hose ⁴ | | AH2-72 hose ⁴ | |
| | Flush | Sleeve/ Skirt | Flush | Sleeve/ Skirt | Flush | Sleeve/ Skirt | Flush | Sleeve/ Skirt | Flush | Sleeve/ Skirt |
| 10 | 8.4 | 8.7 | 8.7 | 9.0 | 9.5 | 9.8 | 10.2 | 10.5 | 11.0 | 11.3 |
| 16 | 9.4 | 9.7 | 9.7 | 10.0 | 10.5 | 10.8 | 11.2 | 11.5 | 12.0 | 12.3 |
| 18 | 9.7 | 10.0 | 10.0 | 10.3 | 10.8 | 11.1 | 11.5 | 11.8 | 12.3 | 12.6 |
| 20 | 10.0 | 10.3 | 10.3 | 10.6 | 11.1 | 11.4 | 11.8 | 12.1 | 12.6 | 12.9 |
| 22 | 10.4 | 10.7 | 10.7 | 11.0 | 11.5 | 11.8 | 12.2 | 12.5 | 13.0 | 13.3 |
| 24 | 10.7 | 11.0 | 11.0 | 11.3 | 11.8 | 12.1 | 12.5 | 12.8 | 13.5 | 13.6 |
| 26 | 11.0 | 11.3 | 11.3 | 11.6 | 12.1 | 12.4 | 12.8 | 13.1 | 13.6 | 13.9 |
| 28 | 11.4 | 11.7 | 11.7 | 12.0 | 12.5 | 12.8 | 13.2 | 13.5 | 14.0 | 14.3 |
| 30 | 11.7 | 12.0 | 12.0 | 12.3 | 12.8 | 13.1 | 13.5 | 13.8 | 14.3 | 14.6 |

Note:

- 3 Order length "A" is determined by the chart "Sprinkler Barrel Length Selection" on page 5.
- 4 Reducer not included with AB6 assembly. Nominal hose lengths include 5.75"/140mm standard reducer for wet systems. Please make appropriate deductions when calculating necessary hose lengths.

 **WARNING**

- It is the responsibility of the system designer to verify suitability of Type 304/304L stainless steel flexible hose for use with the intended fluid media.
- The effect of chemical composition, pH level, operating temperature, chloride level, oxygen level, and flow rate on Type 304/304L stainless steel flexible hose must be evaluated by the material specifier to confirm system life will be acceptable for the intended service.

Failure to follow these instructions could cause product failure, resulting in serious personal injury and/or property damage.

