

Victaulic Isolation Outlet

Styles 929, 929D, 629, 429



1.0 PRODUCT DESCRIPTION

Available Sizes

- 2 ½ – 10"/DN65 – DN250

Pipe Material

- Carbon steel
- Stainless Steel
- Copper

Maximum Working Pressure

- Style 929 and 929D 500 psi
- Style 629 300 psi
- Style 429 300 psi

Operating Temperature

- Dependent on gasket selection from section 3.0

2.0 CERTIFICATION/LISTINGS

3.0 SPECIFICATIONS – MATERIAL

Series 722 Brass Body Ball Valve (NPT)

- Body:** Forged brass, per ASTM B124
- Ball:** Brass, chrome plated, per ASTM B124
- Stem:** Brass, per ASTM B124
- Seat:** Polytetrafluoroethylene (PTFE)
- Handle:** Carbon steel, zinc plated, with vinyl grip
- Stem Nut:** Carbon steel, zinc plated
- Stem Washer:** Polytetrafluoroethylene (PTFE)
- O-Ring:** Fluoroelastomer

NOTE:

- Style 629 utilizes the 722L Brass Body Ball Valve

ALWAYS REFER TO ANY NOTIFICATIONS AT THE END OF THIS DOCUMENT REGARDING PRODUCT INSTALLATION, MAINTENANCE OR SUPPORT.

3.0 SPECIFICATIONS – MATERIAL (CONTINUED)

Pipe Nipples:

Style 929: Schedule 40 carbon steel

Style 929D: Dielectric

Style 629: Dielectric

Style 429: Schedule 40 Stainless steel

Style 929/929D

Housing Material/Coating: Ductile iron conforming to ASTM A-536, grade 65-45-12, with black enamel

Style 629

Upper Housing: Cast bronze conforming to ASTM B584 UNS C89836

Lower Housing/Coating: Ductile iron conforming to ASTM A536, Grade 65-45-12, with copper coating

Style 429

Outlet Housing: Grade CF8M (Type 316 stainless steel) conforming to ASTM A351/A351M

Lower Housing: Ductile iron conforming to ASTM A536, Grade 65-45-12, hot dip galvanized

Optional: Grade CF8M (Type 316 stainless steel) conforming to ASTM A351/A351M

Gasket: (Specify choice*)

Grade “E” EPDM – Style 929, 929D, and 429

EPDM (Green color code). Temperature range –30°F to +230°F/–34°C to +110°C. Recommended for cold and hot water service within the specified temperature range plus a variety of dilute acids, oil-free air and many chemical services. UL Classified in accordance with ANSI/NSF 61 for cold +86°F/+30°C and hot +180°F/+82°C. NOT RECOMMENDED FOR PETROLEUM SERVICES.

Grade “P” Fluoroelastomer Blend – Style 629

P (Double blue stripe color code). Temperature range +0°F to +180°F/–18°C to +82°C. Specifically formulated for compatibility with potable water systems. Optimized for improved resistance to chlorine, chloramine and other typical potable water disinfectants. UL Classified in accordance with NSF/ANSI/CAN 61 for cold +73°F/+23°C and hot +180°F/+82°C potable water service and NSF/ANSI/CAN 372.

NOTES:

- Services listed are General Service Guidelines only. It should be noted that there are services for which these gaskets are not compatible. Reference should always be made to [publication 05.01](#), Victaulic Gasket Selection Guide for specific gasket service guidelines and for a listing of services which are not compatible.

Bolts/Nuts: (specify choice²)

Standard: Carbon steel oval neck track bolts meeting the mechanical property requirements of ASTM A449 (imperial) and ISO 898-1 Class 9.8 (M10-M16) Class 8.8 (M20 and greater). Carbon steel hex nuts meeting the mechanical property requirements of ASTM A563 Grade B (imperial – heavy hex nuts) and ASTM A563M Class 9 (metric – hex nuts). Track bolts and hex nuts are zinc electroplated per ASTM B633 FE/ZN5, finish Type III (imperial) or Type II (metric).

Optional: Stainless steel oval neck track bolts meeting the mechanical property requirements of ASTM A193 Grade B8M, Class 2 (316 stainless steel). Stainless steel heavy hex nuts meeting the mechanical property requirements of ASTM A194 Grade 8M (316 stainless steel), condition CW, with galling reducing coating.²

² Optional bolts/nuts are available in imperial size only.

NOTE

- Carbon steel oval neck track bolts are the standard offering for the galvanized ductile iron lower housing option. Stainless steel oval neck track bolts are the standard offering for the stainless steel lower strap option.

Series 647: The Style 647 dielectric transition fittings are a copper silicon casting conforming to UNS C87850.

4.0 DIMENSIONS

Style 929

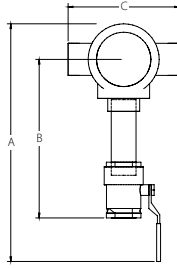

Size	Dimensions		
	A DIM inches mm	B DIM inches mm	C DIM inches mm
2 x 1/2	10.25 260.4	6.63 168.3	5.38 136.5
	11.00 279.4	6.88 174.6	5.38 136.5
	12.00 304.8	8.13 206.4	5.38 136.5
	12.38 314.3	8.69 220.7	5.38 136.5
	14.19 360.4	9.00 228.6	5.38 136.5
2 1/2 x 1/2	10.69 271.5	6.81 173.0	5.63 142.9
	11.44 290.5	7.06 179.4	5.63 142.9
	12.44 315.9	8.31 211.1	5.63 142.9
	12.88 327.0	8.94 227.0	5.63 142.9
	14.69 373.1	9.25 235.0	5.63 142.9
3 x 1/2	11.44 290.5	7.13 181.0	6.13 155.6
	12.19 309.6	7.38 187.3	6.13 155.6
	13.25 336.6	8.63 219.1	6.13 155.6
	13.56 344.5	9.19 233.4	6.13 155.6
	15.63 396.9	9.75 247.7	6.13 155.6
	15.81 401.6	10.19 258.8	6.13 155.6
4 x 1/2	12.38 314.3	7.69 195.3	7.00 177.8
	13.13 333.4	7.88 200.0	7.00 177.8
	14.13 358.8	9.13 231.8	7.00 177.8
	14.50 368.3	9.69 246.1	7.00 177.8
	16.56 420.7	10.25 260.4	7.00 177.8
	16.75 425.5	10.69 271.5	7.00 177.8
6 x 1 1/2	18.75 374.7	11.38 288.9	9.13 231.8
	18.94 481.0	11.81 300.0	9.13 231.8
8 x 2	21.06 738.2	12.88 327.0	12.44 315.9

4.1 DIMENSIONS

Style 929D (Dielectric)

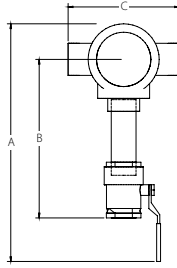

Size	Dimensions		
	A DIM inches mm	B DIM inches mm	C DIM inches mm
2 x 1/2	10.25 260.4	6.63 168.3	5.38 136.5
	11.00 279.4	6.88 174.6	5.38 136.5
	12.00 304.8	8.13 206.4	5.38 136.5
	12.38 314.3	8.69 220.7	5.38 136.5
	14.19 360.4	9.00 228.6	5.38 136.5
2 1/2 x 1/2	10.69 271.5	6.81 173.0	5.63 142.9
	11.44 290.5	7.06 179.4	5.63 142.9
	12.44 315.9	8.31 211.1	5.63 142.9
	12.88 327.0	8.94 227.0	5.63 142.9
	14.69 373.1	9.25 235.0	5.63 142.9
3 x 1/2	11.44 290.5	7.13 181.0	6.13 155.6
	12.19 309.6	7.38 187.3	6.13 155.6
	13.25 336.6	8.63 219.1	6.13 155.6
	13.56 344.5	9.19 233.4	6.13 155.6
	15.63 396.9	9.75 247.7	6.13 155.6
	15.81 401.6	10.19 258.8	6.13 155.6
4 x 1/2	12.38 314.3	7.69 195.3	7.00 177.8
	13.13 333.4	7.88 200.0	7.00 177.8
	14.13 358.8	9.13 231.8	7.00 177.8
	14.50 368.3	9.69 246.1	7.00 177.8
	16.56 420.7	10.25 260.4	7.00 177.8
	16.75 425.5	10.69 271.5	7.00 177.8
6 x 1 1/2	18.75 374.7	11.38 288.9	9.13 231.8
	18.94 481.0	11.81 300.0	9.13 231.8
8 x 2	21.06 738.2	12.88 327.0	12.44 315.9

4.2 DIMENSIONS

Style 429

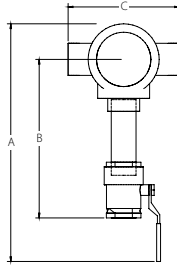

Size	Dimensions		
	A DIM inches mm	B DIM inches mm	C DIM inches mm
2 x ¾	11.06 281.0	6.88 174.6	5.63 142.9
	12.06 306.4	8.13 206.4	5.63 142.9
2 ½ x ¾	11.44 290.5	7.00 177.8	5.88 149.2
	12.56 319.1	8.38 212.7	5.88 149.2
3 x ¾	13.19 335.0	7.88 200.0	6.38 161.9
	14.19 360.4	9.13 231.8	6.38 161.9
	16.06 408.0	9.75 247.7	6.38 161.9
	16.31 414.3	10.19 258.8	6.75 171.5
4 x ¾	13.19 335.0	7.88 200.0	8.13 206.4
	14.19 360.4	9.13 231.8	8.13 206.4
	16.56 420.7	10.25 260.4	8.13 206.4
	16.81 427.0	10.69 271.5	8.13 206.4
6 x ¾	15.69 398.5	9.38 238.1	10.63 269.9
	16.81 427.0	10.75 273.1	10.63 269.9
	18.69 474.7	11.38 288.9	10.63 269.9
	18.94 481.0	11.81 300.0	10.63 269.9
8 x ¾	17.94 455.6	10.50 266.7	12.88 327.0
	18.94 481.0	11.75 298.5	12.88 327.0
	20.94 531.8	12.50 317.5	12.88 327.0
	21.19 538.2	12.94 328.6	12.88 327.0
10 x ¾	20.19 512.8	11.63 295.3	14.88 377.8
	21.19 538.2	12.88 327.0	14.88 377.8
	23.06 585.8	13.50 342.9	14.88 377.8
	23.31 591.2	13.94 354.0	14.88 377.8

4.3 DIMENSIONS

Style 629

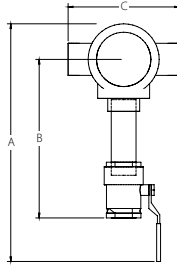

Size	Dimensions		
	A DIM inches mm	B DIM inches mm	C DIM inches mm
2 1/2 x 3/4	11.25 285.8	6.94 176.2	5.88 149.2
	12.25 311.2	8.19 208.0	5.88 149.2
	14.44 366.7	9.13 231.8	6.06 154.0
3 x 3/4	11.81 300.0	7.19 182.6	6.31 160.3
	12.88 327.2	8.44 214.3	0.31 7.9
	15.25 387.4	9.56 242.9	6.31 160.3
4 x 3/4	12.75 323.9	7.69 195.3	7.25 184.2
	13.75 349.3	8.94 227.0	7.25 184.2
	16.19 411.2	10.06 255.6	7.25 184.2

5.0 COMPONENT PERFORMANCE

Style 929/929D

- For performance data please refer to submittals [11.02](#) and [08.15](#)

Style 629

- For performance data please refer to submittal [22.12](#) and [08.15](#)

Style 429

- For performance data please refer to submittal [17.02](#) and [08.15](#)

6.0 NOTIFICATIONS

WARNING



- Read and understand all instructions before attempting to install, remove, adjust, or maintain any Victaulic piping products.
- Depressurize and drain the piping system before attempting to install, remove, adjust, or maintain any Victaulic piping products.
- Wear safety glasses, hardhat, and foot protection.

Failure to follow these instructions could result in death or serious personal injury and property damage.

7.0 REFERENCE MATERIALS

[08.15: Victaulic Brass Body Ball Valve](#)

[11.02: Mechanical-T Bolted Branch Outlet](#)

[17.02: Mechanical-T Bolted Branch Outlet](#)

[22.12: Victaulic Mechanical-T Bolted Branch Outlet & Cross Assembly for Copper Tubing](#)

[22.21: Dielectric Transition Fittings](#)

[I-100: Field Installation Handbook](#)

User Responsibility for Product Selection and Suitability

Each user bears final responsibility for making a determination as to the suitability of Victaulic products for a particular end-use application, in accordance with industry standards and project specifications, and the applicable building codes and related regulations as well as Victaulic performance, maintenance, safety, and warning instructions. Nothing in this or any other document, nor any verbal recommendation, advice, or opinion from any Victaulic employee, shall be deemed to alter, vary, supersede, or waive any provision of Victaulic Company's standard conditions of sale, installation guide, or this disclaimer.

Intellectual Property Rights

No statement contained herein concerning a possible or suggested use of any material, product, service, or design is intended, or should be construed, to grant any license under any patent or other intellectual property right of Victaulic or any of its subsidiaries or affiliates covering such use or design, or as a recommendation for the use of such material, product, service, or design in the infringement of any patent or other intellectual property right. The terms "Patented" or "Patent Pending" refer to design or utility patents or patent applications for articles and/or methods of use in the United States and/or other countries.

Note

This product shall be manufactured by Victaulic or to Victaulic specifications. All products to be installed in accordance with current Victaulic installation/assembly instructions. Victaulic reserves the right to change product specifications, designs and standard equipment without notice and without incurring obligations.

Installation

Reference should always be made to the Victaulic installation handbook or installation instructions of the product you are installing. Handbooks are included with each shipment of Victaulic products, providing complete installation and assembly data, and are available in PDF format on our website at www.victaulic.com.

Warranty

Refer to the Warranty section of the current Price List or contact Victaulic for details.

Trademarks

Victaulic and all other Victaulic marks are the trademarks or registered trademarks of Victaulic Company, and/or its affiliated entities, in the U.S. and/or other countries.