

Copper Tubing Roll Groove Specifications

1.0 SPECIFICATIONS

Copper Tubing to CTS US Standards - ASTM B88 & ASTM B306

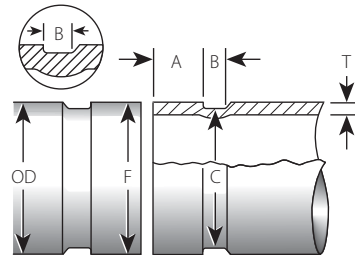

Exaggerated for Clarity

Nominal Size	Pipe Outside Diameter ¹		Dimensions						
	Tubing inches	Basic inches mm	Tolerance inches mm	Gasket Seat "A" ² ±0.03 ±0.76 inches mm	Groove Width "B" ³ +0.03/-0.00 +0.76/-0.00 inches mm	Groove Dia. "C" ⁴ +0.000/-0.020 +0.00/-0.50 inches mm	Groove Depth "D" ⁵ (ref.) ⁵ inches mm	Min. Allow. Wall Thick. "T" ⁶ inches mm	Max. Allow. Flare Diameter "F" ⁷ inches mm
2	2.125	54.0	0.002 0.05	0.610 15.5	0.300 7.6	2.029 51.5	0.048 1.2	DWV	2.174 55.2
2½	2.625	66.7	0.002 0.05	0.610 15.5	0.300 7.6	2.525 64.1	0.050 1.3	0.065 1.7	2.674 67.9
3	3.125	79.4	0.002 0.05	0.610 15.5	0.300 7.6	3.025 76.8	0.050 1.3	DWV	3.174 80.6
4	4.125	104.8	0.002 0.05	0.610 15.5	0.300 7.6	4.019 102.1	0.053 1.4	DWV	4.174 106.0
5	5.125	130.2	0.002 0.05	0.610 15.5	0.300 7.6	4.999 127.0	0.063 1.6	DWV	5.220 132.6
6	6.125	155.6	0.002 0.05	0.610 15.5	0.300 7.6	5.999 152.3	0.063 1.6	DWV	6.220 158.0
8	8.125	206.4	0.002/-0.004 0.05/-0.10	0.610 15.5	0.300 7.6	7.959 202.2	0.083 2.1	DWV	8.220 208.0

- 1 Outside diameter: The outside diameter and tolerances of roll grooved tubing shall be in accordance with the standard referenced above. The maximum allowable tolerance from square cut ends is 0.030"/0.76 mm for 2 – 3"/50 – 80 mm and 0.045"/1.14 mm for 4 – 8"/100 – 200 mm, measured from true square line.
- 2 Gasket seat: The tubing surface shall be free from indentations, roll marks and projections from the end of the tubing to the groove to provide a leak-tight seal for the gasket. All loose scale, dirt, chips and grease must be removed.
- 3 Groove width: The bottom of the groove shall be free of loose dirt, chips and scale that may interfere with proper coupling assembly.
- 4 Groove outside diameter: The groove must be uniform depth for the entire tubing circumference. Groove must be maintained within the "C" diameter tolerance listed.
- 5 Groove depth: For reference only. Groove must conform to the groove diameter "C" listed.
- 6 ASTM B306 drain waste and vent (DWV) is minimum wall thickness copper tubing which may be roll grooved.
- 7 Maximum allowable end flare diameter. Measured at the most extreme tubing end diameter.

ALWAYS REFER TO ANY NOTIFICATIONS AT THE END OF THIS DOCUMENT REGARDING PRODUCT INSTALLATION, MAINTENANCE OR SUPPORT.

System No.		Location	
Submitted By		Date	

Spec Section		Paragraph	
Approved		Date	

1.0 SPECIFICATIONS (Continued)

Copper Tubing to European Standards - EN 1057

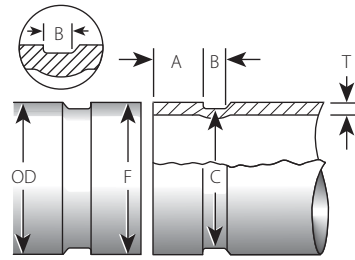

Exaggerated for Clarity

Size	Dimensions										Groove Depth "D" ⁵ (ref.)	Max Allow. Flare Diameter ⁶ "F"
	Actual OD ¹		Gasket Seat "A" ²			Groove Width "B" ³		Groove Diameter "C" ⁴				
Nominal DN	Max. mm inches	Min. mm inches	Basic mm inches	Max. mm inches	Min. mm inches	Max. mm inches	Min. mm inches	Max. mm inches	Min. mm inches			
DN54	54.07 2.129	53.93 2.123	15.87 0.625	16.64 0.655	15.11 0.595	8.38 0.330	7.62 0.300	51.51 2.028	51.00 2.008	1.25 0.049	56.39 2.220	
DN64	64.07 2.522	63.93 2.517	15.87 0.625	16.64 0.655	15.11 0.595	8.38 0.330	7.62 0.300	61.47 2.420	60.96 2.400	1.27 0.050	66.41 2.615	
DN66.7	66.77 2.629	66.63 2.623	15.87 0.625	16.64 0.655	15.11 0.595	8.38 0.330	7.62 0.300	64.14 2.525	63.63 2.505	1.27 0.050	69.09 2.720	
DN76.1	76.17 2.999	76.03 2.993	15.87 0.625	16.64 0.655	15.11 0.595	8.38 0.330	7.62 0.300	73.41 2.890	72.90 2.870	1.35 0.053	78.61 3.095	
DN88.9	88.97 3.503	88.83 3.497	15.87 0.625	16.64 0.655	15.11 0.595	8.38 0.330	7.62 0.300	85.70 3.374	85.19 3.354	1.60 0.063	91.63 3.607	
DN108	108.07 4.255	107.93 4.249	15.87 0.625	16.64 0.655	15.11 0.595	8.38 0.330	7.62 0.300	104.80 4.126	104.29 4.106	1.60 0.063	110.54 4.352	
DN133	133.20 5.244	132.80 5.228	15.87 0.625	16.64 0.655	15.11 0.595	8.38 0.330	7.62 0.300	129.29 5.090	128.78 5.070	1.85 0.073	135.79 5.346	
DN159	159.20 6.280	158.80 6.252	15.87 0.625	16.64 0.655	15.11 0.595	8.38 0.330	7.62 0.300	155.30 6.114	154.79 6.094	1.85 0.073	161.80 6.370	

- 1 Outside diameter: The outside diameter and tolerances of roll grooved tubing shall be in accordance with the standard referenced above. The maximum allowable tolerance from square cut ends is 0.030"/0.76 mm for 2 – 3"/50 – 80 mm and; 0.045"/1.14 mm for 4 – 8"/100 – 200 mm, measured from true square line.
- 2 Gasket seat: The tubing surface shall be free from indentations, roll marks and projections from the end of the tubing to the groove to provide a leak-tight seal for the gasket. All loose scale, dirt, chips and grease must be removed.
- 3 Groove width: The bottom of the groove shall be free of loose dirt, chips and scale that may interfere with proper coupling assembly.
- 4 Groove outside diameter: The groove must be uniform depth for the entire tubing circumference. Groove must be maintained within the "C" diameter tolerance listed.
- 5 Groove depth: For reference only. Groove must conform to the groove diameter "C" listed.
- 6 Maximum allowable end flare diameter. Measured at the most extreme tubing end diameter.

1.0 SPECIFICATIONS (Continued)

Copper Tubing to Australian Standards - AS 1432

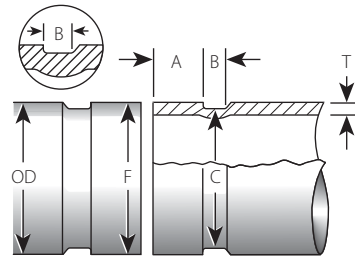

Exaggerated for Clarity

Size	Dimensions										Groove Depth "D" ⁵ (ref.)	Max Allow. Flare Diameter ⁶ "F"
	Actual OD ¹		Gasket Seat "A" ²			Groove Width "B" ³		Groove Diameter "C" ⁴				
Nominal DN	Max. mm inches	Min. mm inches	Basic mm inches	Max. mm inches	Min. mm inches	Max. mm inches	Min. mm inches	Max. mm inches	Min. mm inches			
DN50	50.80 2.000	50.67 1.995	15.87 0.625	16.64 0.655	15.11 0.595	8.38 0.330	7.62 0.300	48.23 1.899	47.73 1.879	1.25 0.049	53.06 2.089	
DN65	63.50 2.500	63.35 2.494	15.87 0.625	16.64 0.655	15.11 0.595	8.38 0.330	7.62 0.300	60.88 2.397	60.38 2.377	1.27 0.050	65.83 2.592	
DN80	76.20 3.000	76.02 2.993	15.87 0.625	16.64 0.655	15.11 0.595	8.38 0.330	7.62 0.300	73.56 2.896	73.05 2.876	1.27 0.050	78.51 3.091	
DN100	101.60 4.000	101.35 3.990	15.87 0.625	16.64 0.655	15.11 0.595	8.38 0.330	7.62 0.300	98.78 3.889	98.27 3.869	1.35 0.053	103.88 4.090	
DN125	127.00 5.000	126.75 4.990	15.87 0.625	16.64 0.655	15.11 0.595	8.38 0.330	7.62 0.300	123.67 4.869	123.16 4.849	1.60 0.063	128.77 5.070	
DN150	152.40 6.000	152.10 5.988	15.87 0.625	16.64 0.655	15.11 0.595	8.38 0.330	7.62 0.300	149.05 5.868	148.54 5.848	1.60 0.063	154.66 6.089	
DN200	203.20 8.000	202.80 7.984	15.87 0.625	16.64 0.655	15.11 0.595	8.38 0.330	7.62 0.300	199.80 7.866	199.29 7.846	1.60 0.063	205.80 8.102	

- 1 Outside diameter: The outside diameter and tolerances of roll grooved tubing shall be in accordance with the standard referenced above. The maximum allowable tolerance from square cut ends is 0.030"/0.76 mm for 2 – 3"/50 – 80 mm and; 0.045"/1.14 mm for 4 – 8"/100 – 200 mm, measured from true square line.
- 2 Gasket seat: The tubing surface shall be free from indentations, roll marks and projections from the end of the tubing to the groove to provide a leak-tight seal for the gasket. All loose scale, dirt, chips and grease must be removed.
- 3 Groove width: The bottom of the groove shall be free of loose dirt, chips and scale that may interfere with proper coupling assembly.
- 4 Groove outside diameter: The groove must be uniform depth for the entire tubing circumference. Groove must be maintained within the "C" diameter tolerance listed.
- 5 Groove depth: For reference only. Groove must conform to the groove diameter "C" listed.
- 6 Maximum allowable end flare diameter. Measured at the most extreme tubing end diameter.

2.0 NOTIFICATIONS



CAUTION

- **DO NOT** use grooving rolls intended for steel, stainless steel, aluminium, or PVC pipe when preparing copper tubing for use with Victaulic copper connection system products.

Failure to follow this instruction could cause joint leakage, resulting in property damage.

3.0 REFERENCE MATERIALS

[22.01: Victaulic Copper Connection Systems for Copper Tubing \(CTS\)](#)

[22.04: Victaulic Copper Fittings](#)

[22.10: Victaulic Australian Standard Copper Products](#)

[22.11: Victaulic EN 1057 Standard Copper Products](#)

[22.15: Victaulic Installation-Ready™ Fittings for Grooved Copper Tube](#)

[I-600: Victaulic Field Assembly and Installation Instruction Handbook for Copper Products](#)

[I-670/671: Victaulic Style 670 \(90 Degree Elbow\) and Style 671 \(45 Degree Elbow\) Installation-Ready™ Fittings for Copper Tubing Installation Instructions](#)

User Responsibility for Product Selection and Suitability

Each user bears final responsibility for making a determination as to the suitability of Victaulic products for a particular end-use application, in accordance with industry standards and project specifications, and the applicable building codes and related regulations as well as Victaulic performance, maintenance, safety, and warning instructions. Nothing in this or any other document, nor any verbal recommendation, advice, or opinion from any Victaulic employee, shall be deemed to alter, vary, supersede, or waive any provision of Victaulic Company's standard conditions of sale, installation guide, or this disclaimer.

Intellectual Property Rights

No statement contained herein concerning a possible or suggested use of any material, product, service, or design is intended, or should be construed, to grant any license under any patent or other intellectual property right of Victaulic or any of its subsidiaries or affiliates covering such use or design, or as a recommendation for the use of such material, product, service, or design in the infringement of any patent or other intellectual property right. The terms "Patented" or "Patent Pending" refer to design or utility patents or patent applications for articles and/or methods of use in the United States and/or other countries.

Note

This product shall be manufactured by Victaulic or to Victaulic specifications. All products to be installed in accordance with current Victaulic installation/assembly instructions. Victaulic reserves the right to change product specifications, designs and standard equipment without notice and without incurring obligations.

Installation

Reference should always be made to the Victaulic installation handbook or installation instructions of the product you are installing. Handbooks are included with each shipment of Victaulic products, providing complete installation and assembly data, and are available in PDF format on our website at www.victaulic.com.

Warranty

Refer to the Warranty section of the current Price List or contact Victaulic for details.

Trademarks

Victaulic and all other Victaulic marks are the trademarks or registered trademarks of Victaulic Company, and/or its affiliated entities, in the U.S. and/or other countries.