

DIMENSIONS

IGS Roll Groove Specifications

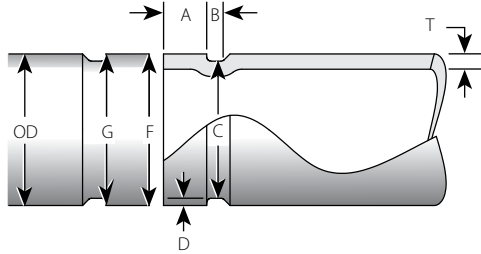

Nominal Size	Pipe Outside Diameter ¹			Gasket Seat "A" ²	Groove Width "B" ³	Groove Diameter "C" ⁴		Groove Depth "D" ⁵ (ref.)	Groove Shoulder "G" ⁶	Allow. Pipe Wall Thk. "T" ⁷	Allow. Flare Dia. "F"	
	inches DN	Actual inches mm	Tolerance			Max inches mm	Min inches mm					
			Max inches mm									Min inches mm
1	1.315	1.330	1.300	.375±.030	.150 +.010/ -.010	1.190	1.170	0.063	1.260	0.109	1.350	
DN25	33.4	33.8	33.0	9.53±0.76	3.81 + 0.25/ -0.25	30.2	29.7	1.6	32.0	2.8	34.3	

- ¹ **Outside Diameter:** The outside diameter of roll grooved pipe shall not vary more than the tolerance listed.
- ² **Gasket Seat "A":** The pipe surface shall be free from indentations, roll marks and projections from the end of the pipe to the groove to provide a leak-tight seal for the gasket. All loose paint, scale, dirt, chips, grease and rust must be removed. The maximum allowable tolerance from square-cut pipe ends is 1/32"/0.79 mm. This is measured from the true square line. When using beveled end pipe, the gasket seat "A" is measured from the end of the pipe.
- ³ **Groove Width "B":** Bottom of groove to be free of loose dirt, chips, rust and scale that may interfere with proper coupling assembling. Corners at bottom of groove must be radiused.
- ⁴ **Groove Diameter "C":** The groove must be of uniform depth for the entire pipe circumference. Groove must be maintained within the "C" diameter tolerance listed.
- ⁵ **Groove Depth "D":** For reference only. Groove must conform to the groove diameter "C" listed.
- ⁶ **Groove Shoulder "G":** The minimum diameter of the front side of the groove after the pipe has been roll grooved.
- ⁷ The value listed in the table indicates the minimum allowable nominal pipe wall thickness.

NOTES

- The coating thickness applied to the gasket seating surface and within the groove on the pipe exterior shall not exceed .010"/0.025mm.
- For use on schedule 10 and 40 IPS carbon steel pipe. Contact Victaulic for all other pipe material inquiries.
- Roll grooving removes no metal, cold forming a groove by the action of outer grooving rolls being forced into pipe as it is rotated.

ALWAYS REFER TO ANY NOTIFICATIONS AT THE END OF THIS DOCUMENT REGARDING PRODUCT INSTALLATION, MAINTENANCE OR SUPPORT.

System No.		Location	
Submitted By		Date	

Spec Section		Paragraph	
Approved		Date	

DIMENSIONS

IGS Cut Groove Specifications

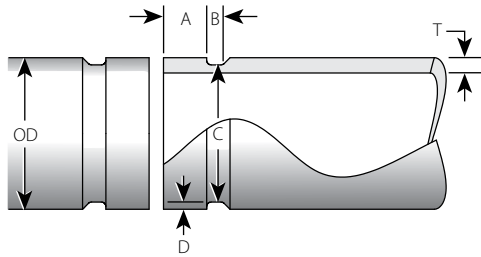

Nominal Size	Pipe Outside Diameter ¹			Gasket Seat "A" ²	Groove Width "B" ³	Groove Diameter "C" ⁴		Groove Depth "D" ⁵ (ref.)	Allowable Pipe Wall Thickness "T" ⁶	
	inches DN	Actual inches mm	Tolerance			Max inches mm	Min inches mm			
			Max inches mm							Min inches mm
1	1.315	1.330	1.300	.375±.030	.140 + .010/-0.000	1.190	1.175	0.063	0.133	
DN25	33.4	33.8	33.0	9.53±0.76	3.56 + 0.25/-0.00	30.2	29.9	1.6	3.4	

- ¹ **Outside diameter:** The outside diameter of roll grooved pipe shall not vary more than the tolerance listed.
- ² **Gasket seat "A":** The pipe surface shall be free from indentations, roll marks and projections from the end of the pipe to the groove to provide a leak-tight seal for the gasket. All loose paint, scale, dirt, chips, grease and rust must be removed. The maximum allowable tolerance from square-cut pipe ends is 1/32"/0.79 mm. This is measured from the true square line. When using beveled end pipe, the gasket seat "A" is measured from the end of the pipe.
- ³ **Groove width "B":** Bottom of groove to be free of loose dirt, chips, rust and scale that may interfere with proper coupling assembling. Corners at bottom of groove must be radiused. (.040"±/.015")
- ⁴ **Groove diameter "C":** The groove must be of uniform depth for the entire pipe circumference. Groove must be maintained within the "C" diameter tolerance listed.
- ⁵ **Groove depth "D":** For reference only. Groove must conform to the groove diameter "C" listed.
- ⁶ The value listed in the table indicates the minimum allowable nominal pipe wall thickness.

NOTES

- The coating thickness applied to the gasket seating surface and within the groove on the pipe exterior shall not exceed .010"/0.025mm.
- For use on schedule 40 IPS carbon steel pipe. Contact Victaulic for all other pipe material inquiries.

REFERENCE MATERIALS

- [10.54: Victaulic IGS Groove System](#)
- [10.85: VicFlex™ Series AH2-CC Hose](#)
- [24.01: Victaulic Pipe Preparation Tools](#)
- [I-100: Victaulic Field Installation Handbook](#)
- [I-101-103 - FireLock™ Installation-Ready™ Fittings Installation Instructions](#)
- [I-102 FireLock™ Installation-Ready™ Fittings Installation Instructions](#)
- [I-108 FireLock™ IGS™ Style 108 Rigid Coupling](#)
- [TM-RG2100 - Operating and Maintenance Instructions Manual](#)

User Responsibility for Product Selection and Suitability

Each user bears final responsibility for making a determination as to the suitability of Victaulic products for a particular end-use application, in accordance with industry standards and project specifications, and the applicable building codes and related regulations as well as Victaulic performance, maintenance, safety, and warning instructions. Nothing in this or any other document, nor any verbal recommendation, advice, or opinion from any Victaulic employee, shall be deemed to alter, vary, supersede, or waive any provision of Victaulic Company's standard conditions of sale, installation guide, or this disclaimer.

Intellectual Property Rights

No statement contained herein concerning a possible or suggested use of any material, product, service, or design is intended, or should be construed, to grant any license under any patent or other intellectual property right of Victaulic or any of its subsidiaries or affiliates covering such use or design, or as a recommendation for the use of such material, product, service, or design in the infringement of any patent or other intellectual property right. The terms "Patented" or "Patent Pending" refer to design or utility patents or patent applications for articles and/or methods of use in the United States and/or other countries.

Note

This product shall be manufactured by Victaulic or to Victaulic specifications. All products to be installed in accordance with current Victaulic installation/assembly instructions. Victaulic reserves the right to change product specifications, designs and standard equipment without notice and without incurring obligations.

Installation

Reference should always be made to the Victaulic installation handbook or installation instructions of the product you are installing. Handbooks are included with each shipment of Victaulic products, providing complete installation and assembly data, and are available in PDF format on our website at www.victaulic.com.

Warranty

Refer to the Warranty section of the current Price List or contact Victaulic for details.

Trademarks

Victaulic and all other Victaulic marks are the trademarks or registered trademarks of Victaulic Company, and/or its affiliated entities, in the U.S. and/or other countries.